



®

# COBRA



# 300

3-PHASE

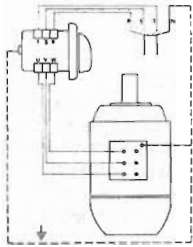

FIG. 3

3-PHASE

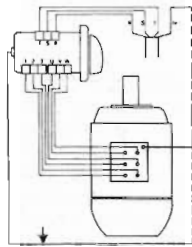

FIG. 4

1-PHASE

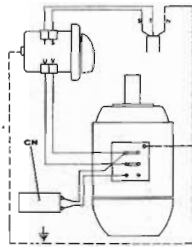

FIG. 5

**COLLEGAMENTO ELETTRICO**  
per macchine di serie

**ELECTRICAL CONNECTION**  
for standard machine

**BRANCHEMENT**  
pour machine standard

**ELEKTROANSCHLUSS**  
für Standard Maschine

**CONEXION ELECTRICA**  
para máquinas standard

3-PHASE

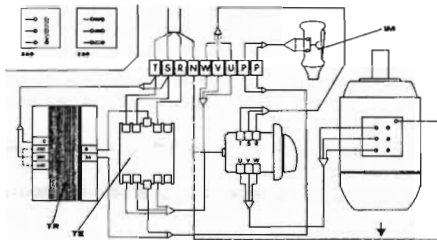

FIG. 6

3-PHASE

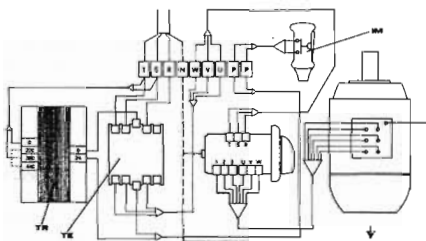

FIG. 7

**COLLEGAMENTO ELETTRICO**  
con dispositivo a bassa tensione volts 24

**ELECTRICAL CONNECTION**  
with low tension device volts 24

**BRANCHEMENT**  
avec dispositif à basse tension volts 24

**ELEKTROANSCHLUSS**  
mit Vorrichtung bei Niederspannung 24 Volt

**CONEXION ELECTRICA**  
con dispositivo a baja tensión volts 24

1-PHASE

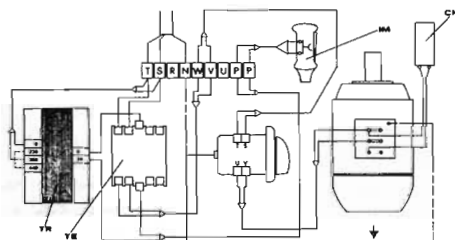
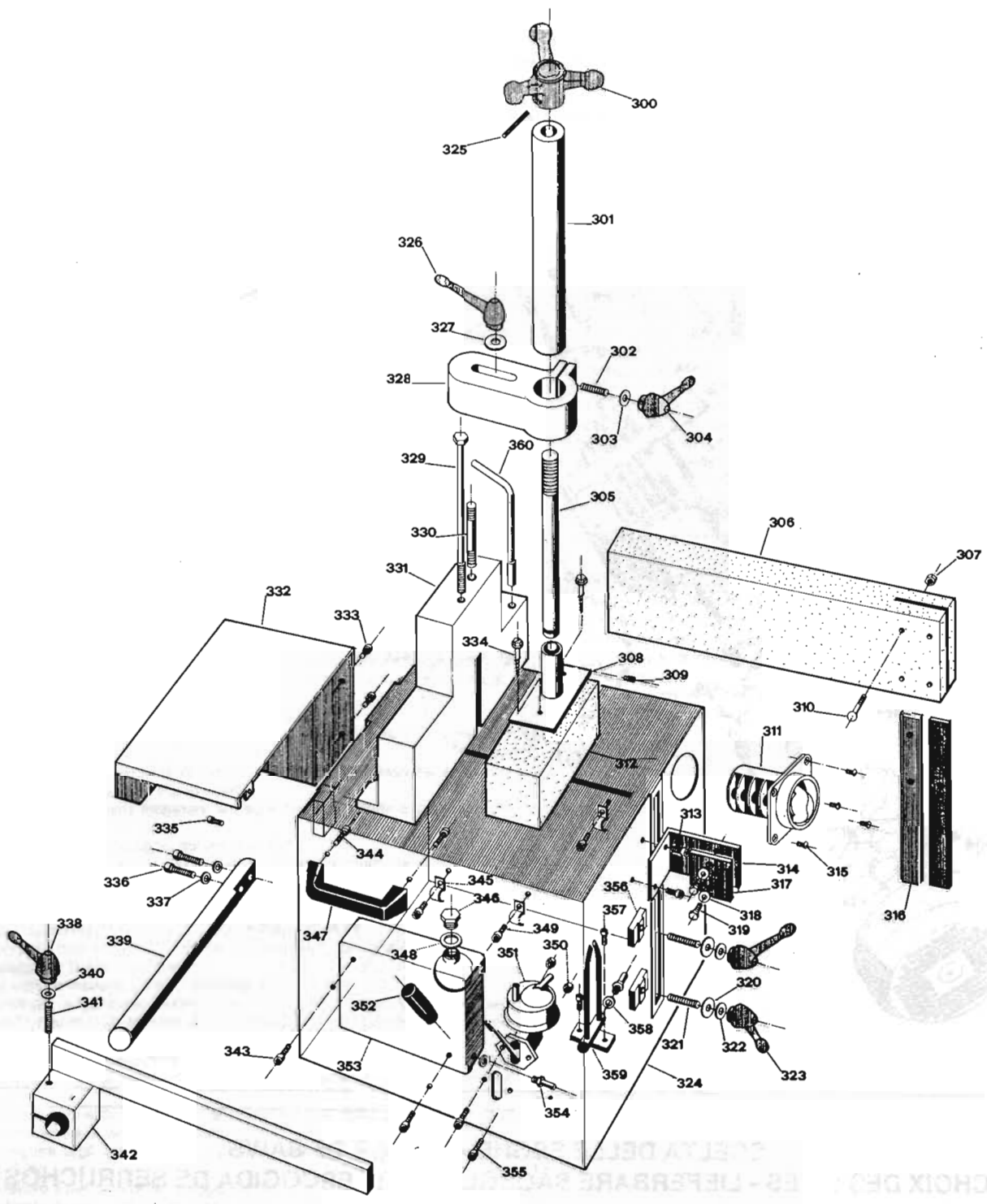
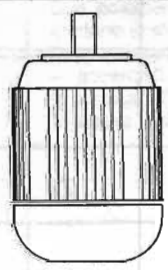

FIG. 8

a	d		d = 300				
32	300		95	85	160x50	180x60	140x85
			95	80	120x50	140x60	110x85



FIG



	1-PHASE	3-PHASE	3-PHASE
HP	3	3	2/3
RPM	3400	3400	1700/3400

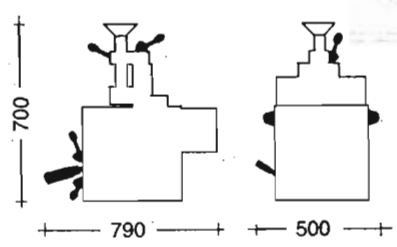

kg	
	90

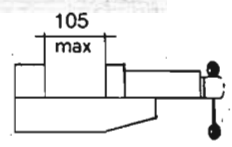

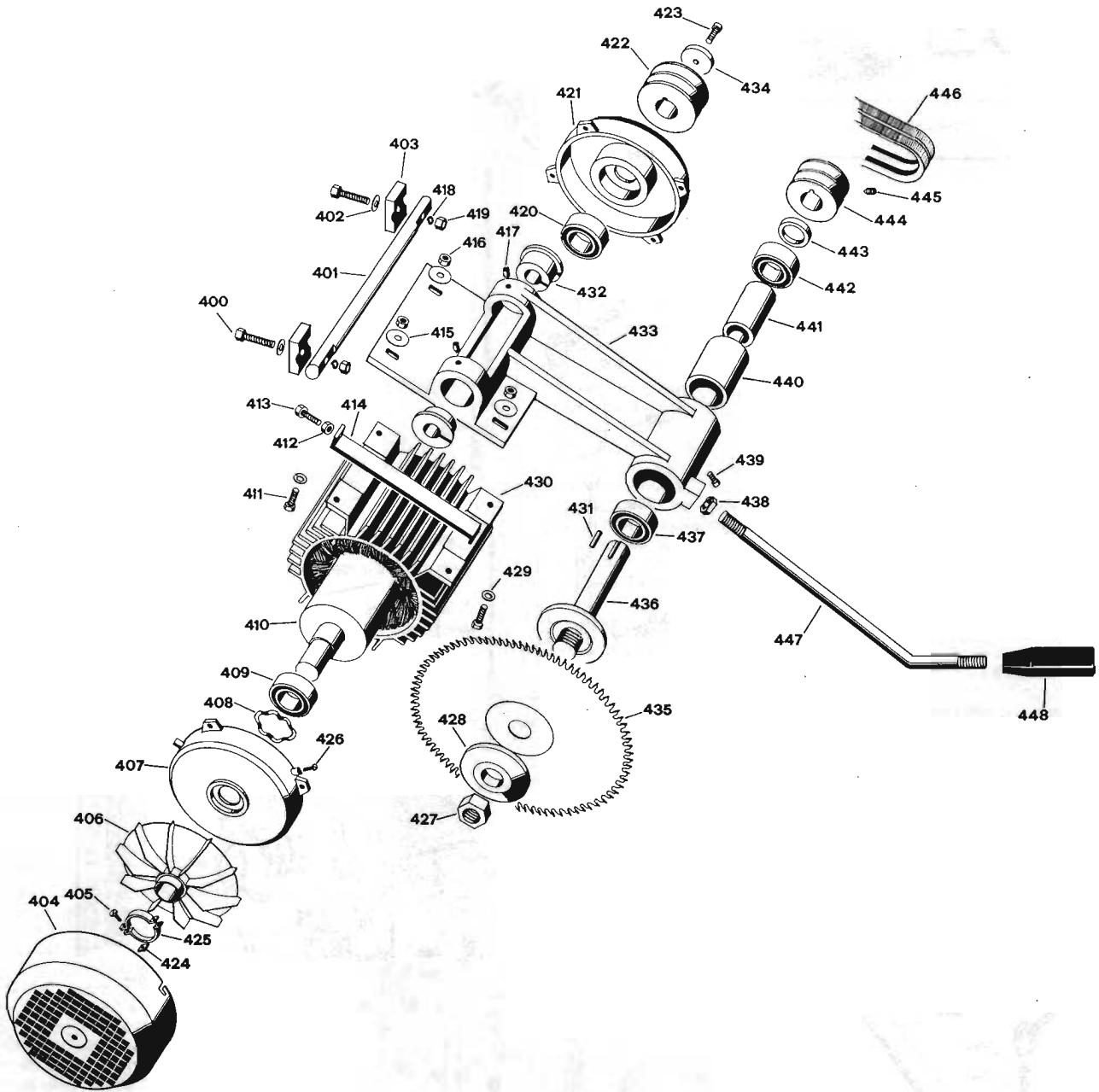

**SCelta DELLE SEGHE - CHOICE OF SAWS  
CHOIX DES SCIES - LIEFERBARE SÄGEGLÄTTER - ESCOGIDA DE SERRUCHOS**

<p>mm. 0.3</p> <p>dentatura N    toothing N</p>		<p>dentatura toothing</p>	<p>∅ disco-blade</p>	<p>Z</p>
<p>N</p>		<p>300</p>	<p>72</p>	
<p>mm. 0.3</p> <p>dentatura P    toothing P</p>		<p>dentatura toothing</p>	<p>∅ disco-blade</p>	<p>Z</p>
<p>P</p>		<p>300</p>	<p>72</p>	